

# Ladungsleger I

Multimedia Conversion kit for DRAGON's Pz.Kpfw. I Ausf B

CAUTION! DO NOT BEND PHOTOETCH PARTS MORE THAN ONCE, OR IT MAY BRAKE

# Ladungsleger I

(Zerstörerpanzer)



Multimedia Conversion kit for DRAGON's Pz.Kpfw. I Ausf B

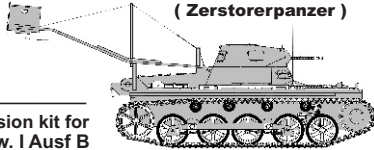

LW 35009 WWW.LEADWARRIOR.COM INFO@LEADWARRIOR.COM COPYRIGHT 2005

PHOTOETCH SET  
6 RESIN PARTS  
3 METAL PARTS

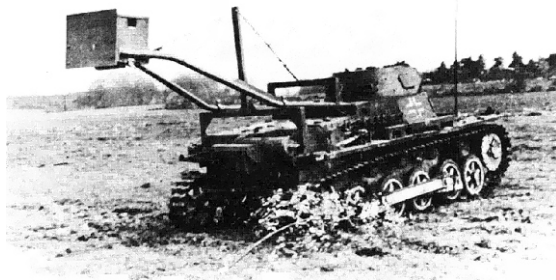

As to the start of WWII the first tank of Wehrmacht, Pz.Kpfw. I, couldn't meet requirements for combat machines anymore, they were sent to training establishments, or converted to different special vehicles. An armored engineer vehicle, Ladungsleger I ("Explosive Charge Layer I") had an arm that could place an explosive charge next to an obstacle or fortification. A contract dated May 9, 1940, was given to Waggonfabrik Talbot of Aachen to construct a vehicle that could place an explosive charge of 75 kg. The arm was 2 m long when retracted and could be extended 2.75 m. 10 Ausf Bs of the 3rd Panzer Pioniere Kp of each Pioneer Battalion in the Panzer Divisions were outfitted.

## Smoke grenades assembly

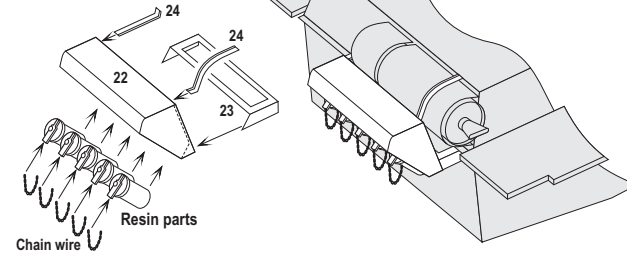

1

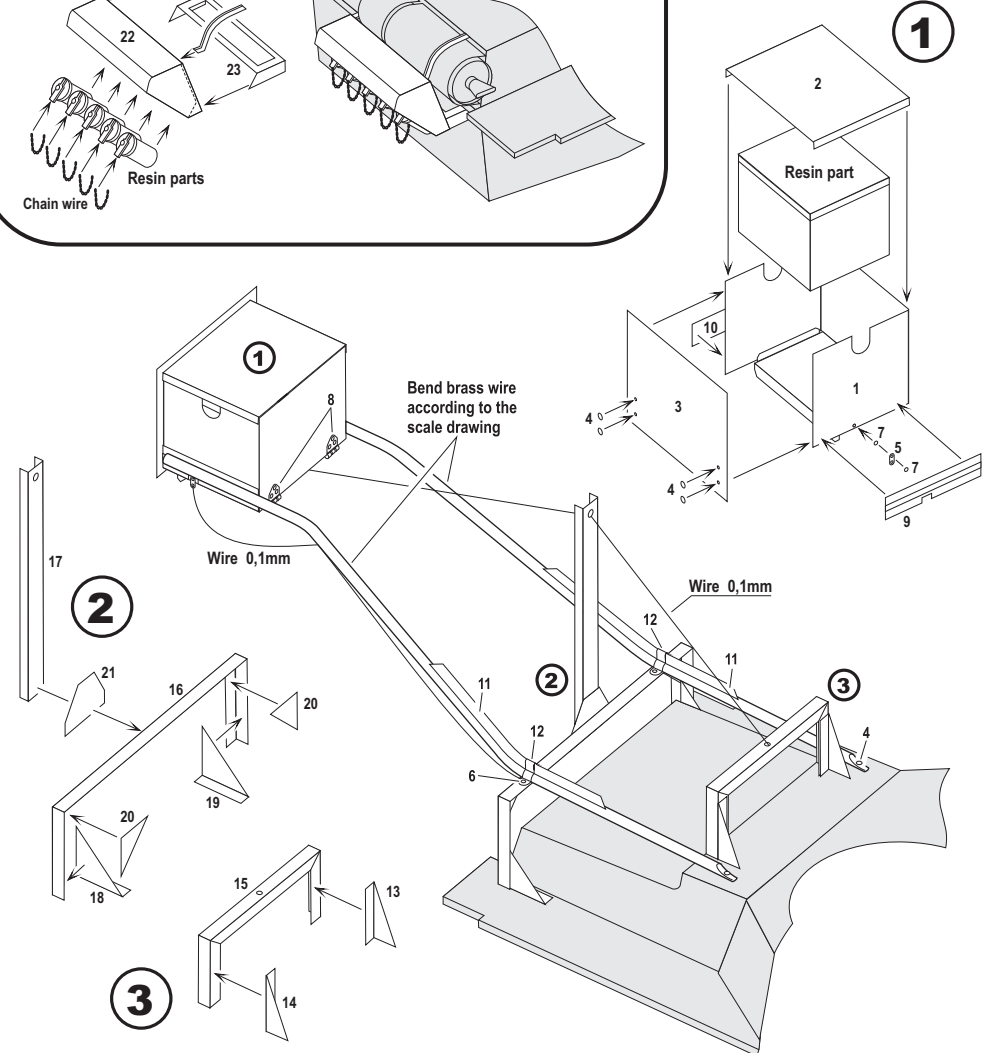

**M 1:35**

